



Jefferson City High School



DLR Group

Architecture Engineering Planning Interiors

Capital City High School



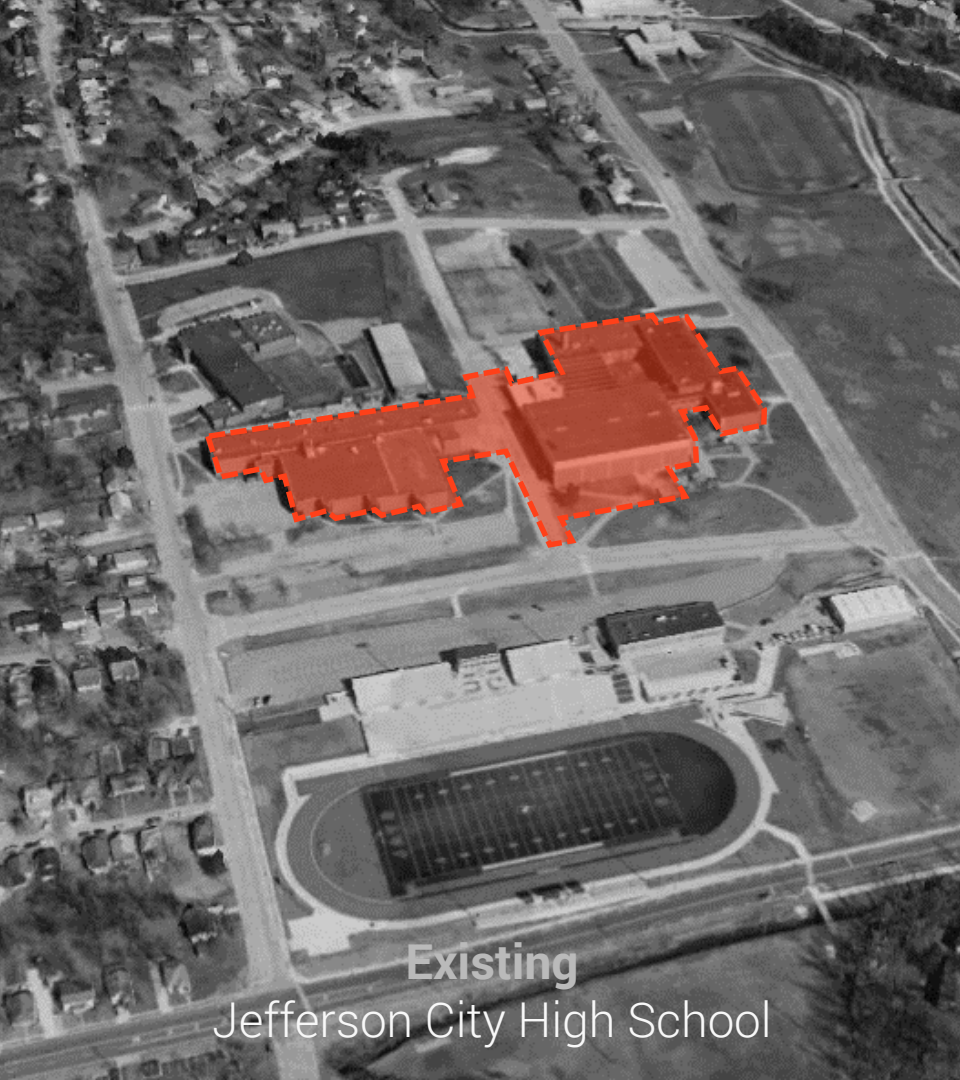

Existing
Jefferson City High School



New
Capital City High School



Current
Jefferson City High School

- A.** Proposed Car Drop-Off with new Curb and Gutter
- B.** Proposed West Entry Plaza with Decorative Pavement.
- C.** Stair Entry Feature with Terraced Seat Walls.
- D.** Existing Parking lot to remain as shown.
- E.** Proposed Covered East Entry Plaza.
- F.** Stair Entry Feature with Integral ADA Ramp.
- G.** Proposed Bus Drop with Heavy-Duty Pavement.
- H.** Service area with Heavy-Duty Pavement.
- I.** Terraced Retaining Walls with Landscaping.
- J.** Proposed Building Addition.

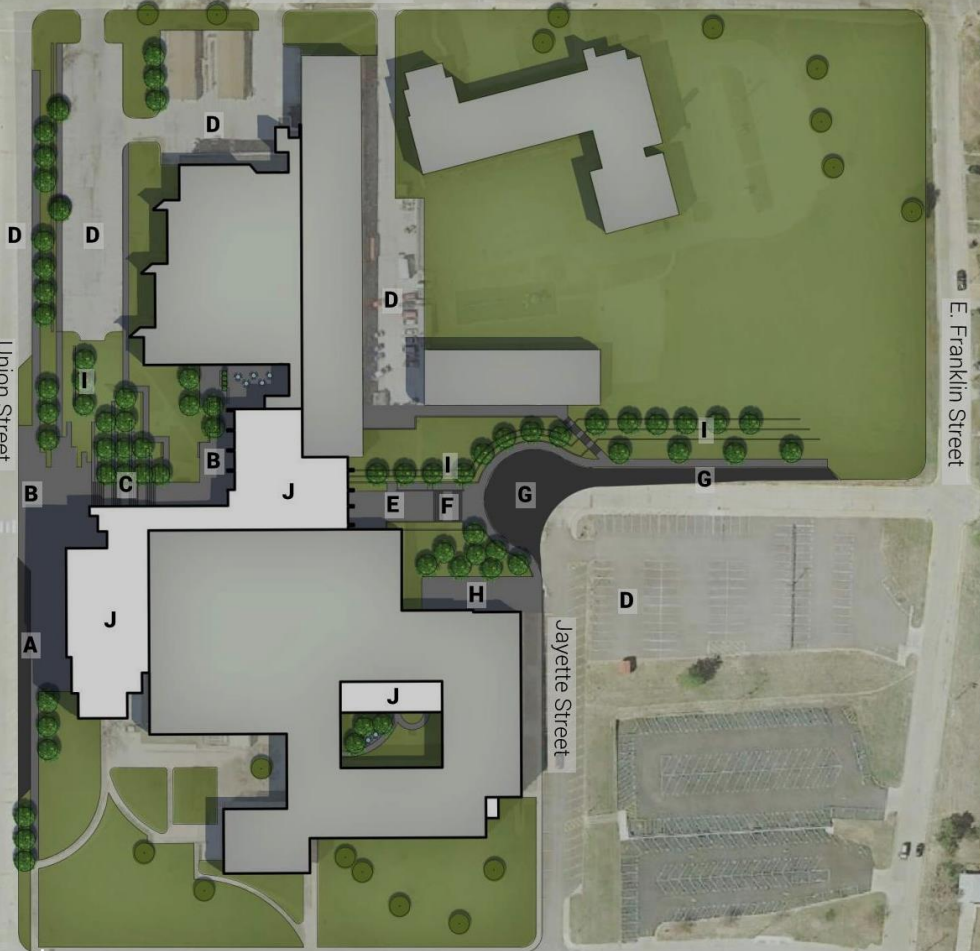

Current
Jefferson City High School

Jackson Street

E. Franklin Street

Union Street

Jayette Street

Lafayette Street

SEE PHASE 1A & 1B-AREA G WEST END PHASE 2 & 5-AREA B PHASE 3-AREA F PHASE 4 PHASE 5-AREA A & B PHASE 6-AREA A PHASE NEW ADDITION PHASE NEW PHASE NEW ADDITION PHASE 1A-AREA G WEST END PHASE 1A-AREA G TOWER PHASE 1A-MOBILE CLASSROOMS

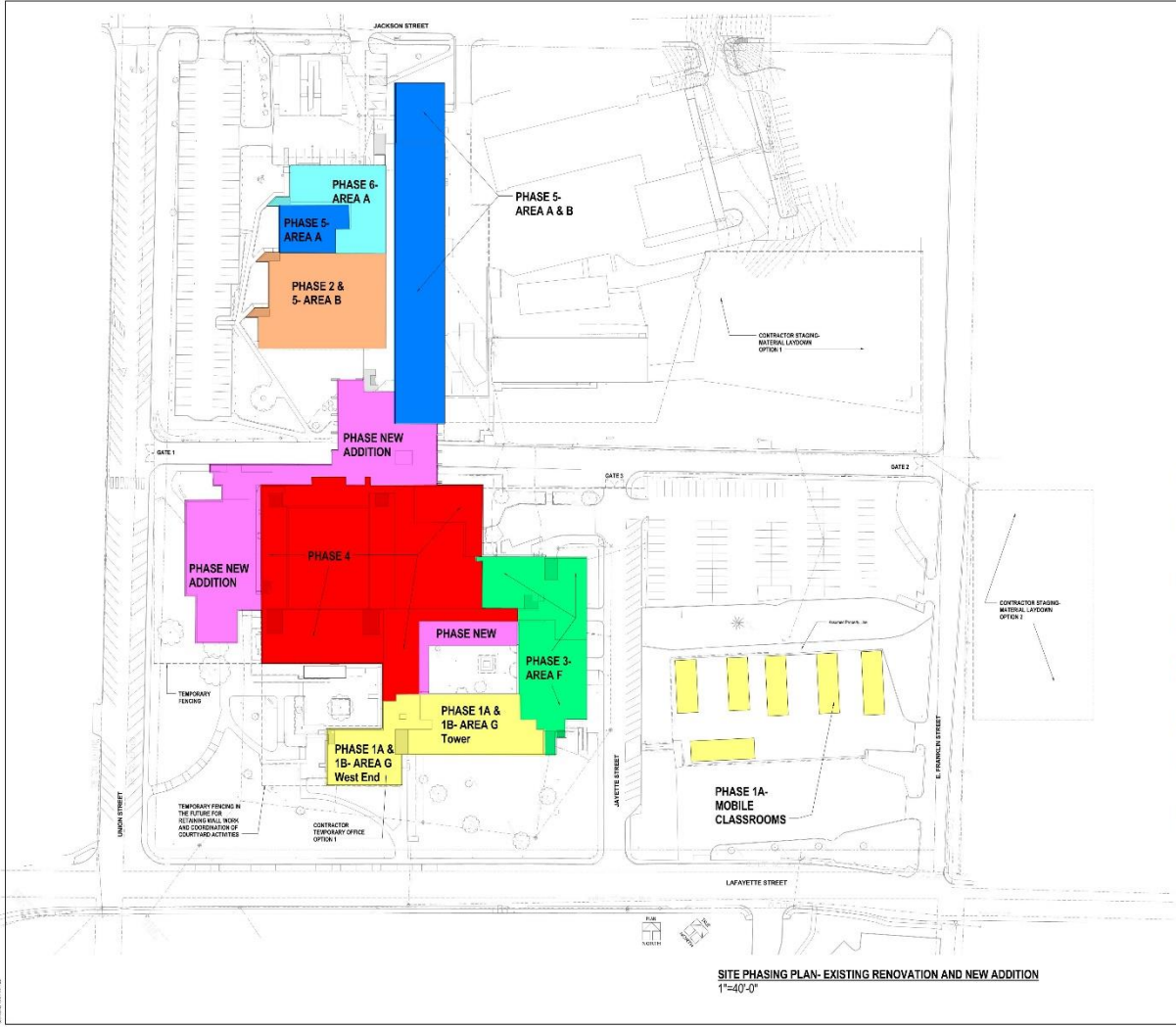

- LEGEND**
- See also larger scaled plans on sheets PH1.1, PH1.2 & PH1.3
- PHASE 1A**
 Area G
 - 1st Flr West End (partial)
 - 4th Floor Tower and Restroom
 - Mobile Classrooms
 - PHASE 1B**
 Area G
 - 1st Flr West End Block Box (remainder)
 - 1st, 2nd and 3rd Floor West End
 - 1st, 2nd and 3rd Floor Tower
 - PHASE 2**
 Area A, 3rd Floor
 Area B, 3rd Floor
 - PHASE 3**
 Area F
 - PHASE 4**
 Area D, 3rd Floor
 Area E, 3rd & 4th Floor
 Area F, 3rd Floor
 Area G, Replacement windows
 - PHASE 5**
 Area A, 4th AND 4TH FLOOR
 - PHASE 6**
 Area A, 4TH FLOOR
 - PHASE NEW**
 Phase 2- New additions

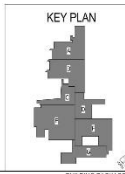

SITE PHASING PLAN- EXISTING RENOVATION AND NEW ADDITION
 1"=40'-0"

DOUGLAS M. MCWHORTER
 LICENSE NO. 11017
 STATE OF MISSOURI
 PROFESSIONAL ENGINEER

PHASE 1A
 PHASE 1B
 PHASE 2
 PHASE 3
 PHASE 4
 PHASE 5
 PHASE 6
 PHASE NEW

SITE PLAN- OVERALL PHASE LOCATIONS
JEFFERSON CITY CURRENT HIGH SCHOOL

PH1.0

DJR Group
 ARCHITECTURE ENGINEERING PLANNING INTERIORS



Jefferson City High School







NOOK

MOVIE OFFICE





Jay NOOK





1:43

NICHOLS













New
Capital City High School



Creek Trail Drive

Practice Field

Proposed City Street

Highway 17

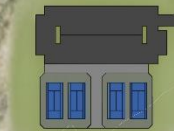

Tennis Courts

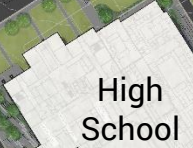

High School



Practice Field

Practice Field

Mission Drive

Phase 1
Capital City High School

OVERALL LAYOUT PLAN



Creek Trail Drive

Proposed City Street

Highway 17

High School

Master Plan Capital City High School

Mission Drive

OVERALL LAYOUT PLAN

Phase 1
Completed
August 2019

Phase 2
Completed
January 2020

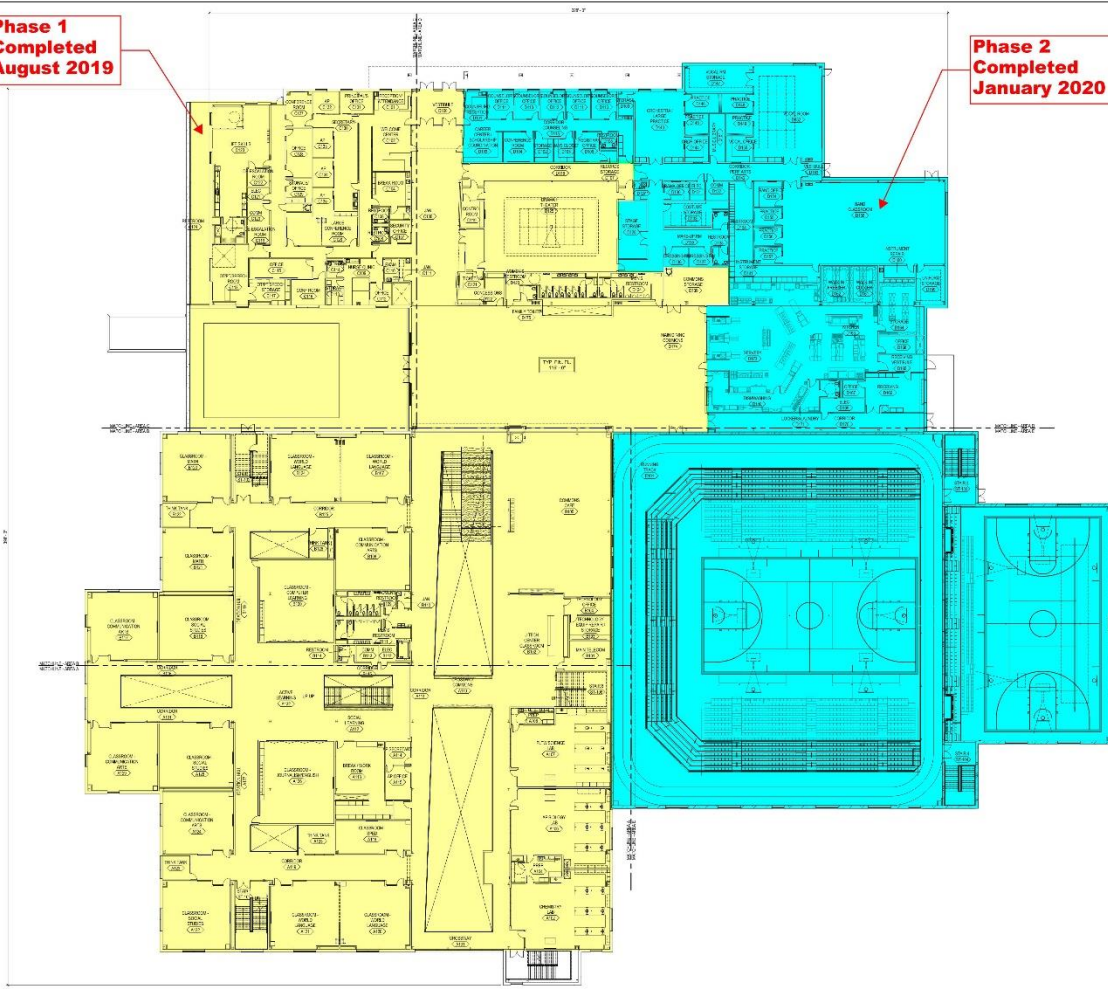

ORIENTATION PLAN - MAIN LEVEL

LEGEND NOTES

100% DESIGN DEVELOPMENT
Author

March 2020
Jefferson City, MO 64506

ORIENTATION PLAN - MAIN LEVEL
JEFFERSON CITY SECOND HIGH SCHOOL

AD.02



KEY PLAN



DLR Group
Architectural, Engineering, Planning, Interior
SC031511-0100

100% DESIGN DEVELOPMENT
JEFFERSON CITY SECOND HIGH SCHOOL
ARCHITECTURAL AND ENGINEERING















opening soon...

